

C-215-88

Michael Shotts

Christopher Herhold

C 75-72

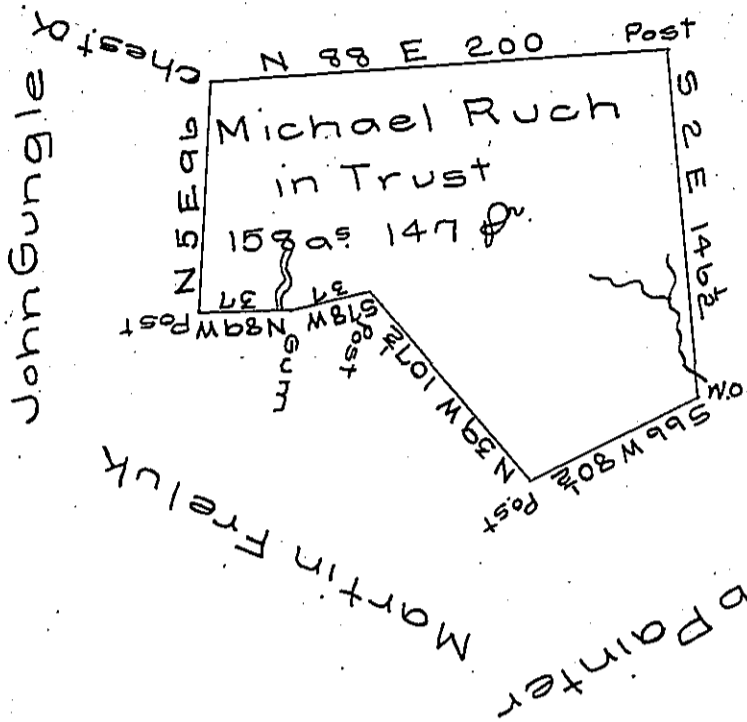

A draught of a tract of land situate in Hem-
 field township Westmoreland County containing
 one hundred fifty eight acres one hundred &
 forty seven $\frac{1}{2}$ and an allowance of six $\frac{1}{2}$ cent
 surveyed on ninth day of Jenuary 1786 in pur-
 suance of a warrant granted Michael Ruch
 in trust to the Leutherian Church bearing
 date August 22nd 1785.

Jn^o Henderson D.S.

To John Lukens Esq^r }
 Surveyor General }

IN TESTIMONY that the above is a copy of the original remaining on file in
 the Department of Internal Affairs of Pennsylvania, made
 conformably to an Act of Assembly approved the 16th day of
 February, 1833, I have hereunto set my Hand and caused
 the Seal of said Department to be affixed at Harrisburg,
 this twenty-seven day of June 1906.

Isaac D. Brown
 Secretary of Internal Affairs.